

Family Genealogy Day at SPENCER-PEIRCE-LITTLE FARM

Saturday, July 15, 2006

10 a.m. - 5 p.m.

————— Newbury, Massachusetts —————

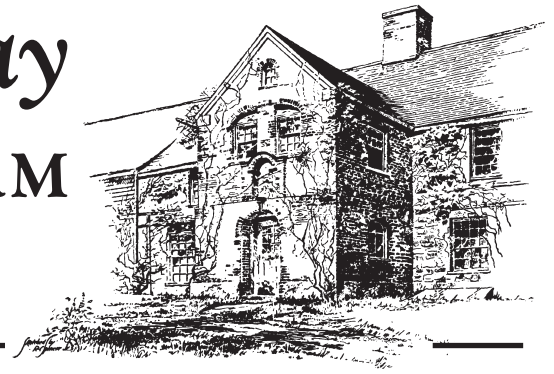

GENEALOGY & LOCAL HISTORY ENTHUSIASTS:

OK, you've collected facts & figures, dates & data.

Now join us for an EXPERIENCE!

From the earliest days of its 17th century settlement, the town of Newbury, Mass. (formerly comprising what is now Newbury, Newburyport, & West Newbury) has been a destination for those looking for family roots. Family Genealogy Day at historic Spencer-Peirce-Little Farm invites all local history enthusiasts to *experience* walking in the footsteps of Newbury's early settlers and to learn how to explore family history. In addition to customized house tours, visitors will receive resource materials that include Newbury research tips, a bibliography of local history sources, and custom-produced maps to local cemeteries and historic sites.

The one-day event includes tours of the Spencer-Peirce-Little House and farm, the Coffin House, and the Swett-Ilsley House, all in Newbury, plus the Rocky Hill Meeting House in Amesbury. The list of individuals related to these properties reads like a who's who of Newbury's earliest settlers. Visitors will also learn about the hired hands and tenant farmers whose lives and labors were just as vital as those of the deeded owners. The event aims to add valuable perspective for any family history enthusiast.

Representatives from the New England Historic Genealogical Society will be on site to dispense research tips and provide guidance to their library resources. The Essex Society of Genealogists and local libraries will also have a presence at the event, describing their local history & genealogy resources.

- Tread in the footsteps of Newbury's early settlers.
- Experience the vastness of a 350-year-old Newbury farm.
- Tour Historic New England's 17th century Newbury properties.
- Gain insight into the evolution of New England domestic life.
- Learn about the techniques & process of family history.
- Take home valuable information about Newbury research.
- Discover ancestors in local burying grounds.
- Network with genealogy & local history enthusiasts.

Advance registration is required. The cost is \$15 for Historic New England members (children free); \$25 for non-members (children \$12). Visitors may register by phone (978-462-2634) or online at www.historicnewengland.org.



**HISTORIC
NEW ENGLAND**

Defining the past. Shaping the future.

Historic New England is the oldest, largest, and most comprehensive regional preservation organization in the U.S., encompassing 36 historic properties, a vast collection & archives, and a wide range of educational & preservation programs.

Regional Office:
Spencer-Peirce-Little Farm
5 Little's Lane
Newbury, MA 01951
(978) 462-2634

————— www.HistoricNewEngland.org —————

Family Genealogy Day

at

SPENCER-PEIRCE-LITTLE FARM

Saturday, July 15, 2006

10 a.m. - 5 p.m.

Newbury, Massachusetts

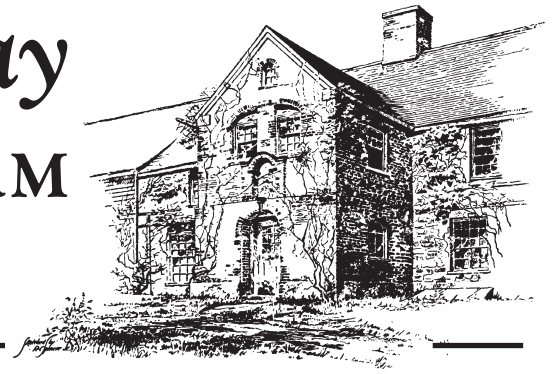

July 15, 2006

Dear Family Genealogy Day Participant:

Welcome to Family Genealogy Day at Spencer-Peirce-Little Farm.

From the earliest days of its 17th century settlement, the town of Newbury, Mass. has been a destination for those looking for family roots. But these days it is easier than ever for family historians to amass mountains of information from a distance – from a distant library or via the internet. The result can be a dry collection of names and dates without much personal context.

Therefore our goal at Family Genealogy Day is to provide you that personal context – and facilitate an *experience* to complement and humanize your collection of names, dates, and data. We want you to *tread in the footsteps* of Newbury's earliest settlers; *feel the vastness* of a 350-year-old farm; and *soak in the atmosphere* of daily life in our museum houses. Whether or not you have ancestors connected to the properties – or to Newbury, our 17th-century properties offer an unparalleled view of the social history, culture, and domestic life of early New England.

On the reverse of this sheet is the day's schedule. Flexibility has been built in so that you can follow your own particular interests. Note that the tours of the Spencer-Peirce-Little House are offered both in the morning and in the afternoon.

Your Family Genealogy Day packet includes information of interest to Newbury researchers, directions to our properties, and more. If you are a researcher, you'll be tempted to dive right into the text immediately. But remember, also on hand at our Visitor Center are knowledgeable representatives from genealogical organizations and libraries who are prepared to answer your questions about Newbury research or genealogy in general.

If you have any questions about our properties or the materials in your packet, don't hesitate to ask a Historic New England guide for answers. Remember, at Family Genealogy Day we want to go beyond the names and dates. We want you to have an *experience*!

R.W. Bacon

Family Genealogy Day at Spencer-Peirce-Little Farm



PLEASE SEE SCHEDULE ON REVERSE OF THIS PAGE!

**HISTORIC
NEW ENGLAND**

Defining the past. Shaping the future.

Historic New England is the oldest, largest, and most comprehensive regional preservation organization in the U.S., encompassing 36 historic properties, a vast collection & archives, and a wide range of educational & preservation programs.

Regional Office:
Spencer-Peirce-Little Farm
5 Little's Lane
Newbury, MA 01951
(978) 462-2634

www.HistoricNewEngland.org



~ Schedule of Tours & Activities ~

(Schedule subject to adjustment)

- 10 a.m.Registration & Orientation at SPL Farm
Introduction to Newbury Local History
- 10 a.m. - 5 p.m.....Genealogy Resources:
Libraries & Organizations* at SPL Farm Visitor Center
- 10 a.m. - 5 p.m.....Self-guided walking tours of Spencer-Peirce-Little Farm
- 11 a.m.Tour - Spencer-Peirce-Little House in the 18th Century
- 11:30 a.m.Tour - Spencer-Peirce-Little House in the 19th Century
- 12 noonTour - Spencer-Peirce-Little House in the 20th Century
- 1 p.m.Lunch (For box lunches ordered at time of pre-registration)
- 11 a.m. - 4 p.m.....Coffin House (tours on the hour), 14 High Road, Newbury, Mass.
- 12 noon - 4 p.m.....Swett-Ilsley House (drop-in tours), 4 High Road, Newbury, Mass.
- 12 noon - 4 p.m.....Tours - Cushing House Museum, 98 High Street, Newburyport, Mass.
- 1 p.m. - 4 p.m.....On-site Orientation
- First Parish Burying Ground, High Road, Newbury, Mass.
- First Settlers Burying Ground, High Road, Newbury, Mass.
- 2 - 4 p.m.....Rocky Hill Meeting House (drop-in tours)
Elm St. & Old Portsmouth Rd., Amesbury, Mass.
- 3:00 p.m.Tour - Spencer-Peirce-Little House in the 18th Century
- 3:30 p.m.Tour - Spencer-Peirce-Little House in the 19th Century
- 4 p.m.Tour - Spencer-Peirce-Little House in the 20th Century
- 4:30 p.m.Concluding Question/Answer Session at SPL Visitor Center

*** Participants
at the SPL Farm
Visitor Center
include**

- New England Historic Genealogical Society
- Newburyport Public Library
- Newbury Public Library
- Historical Society of Old Newbury
(Cushing House Museum)
- Essex Society of Genealogists
- Newbury 375th Anniversary 1635-2010 Committee
- Sons & Daughters of the First Settlers of Newbury, Mass.



Family Genealogy Day at SPENCER-PEIRCE-LITTLE FARM

Newbury, Massachusetts



~ Sites of Historical & Genealogical Interest ~

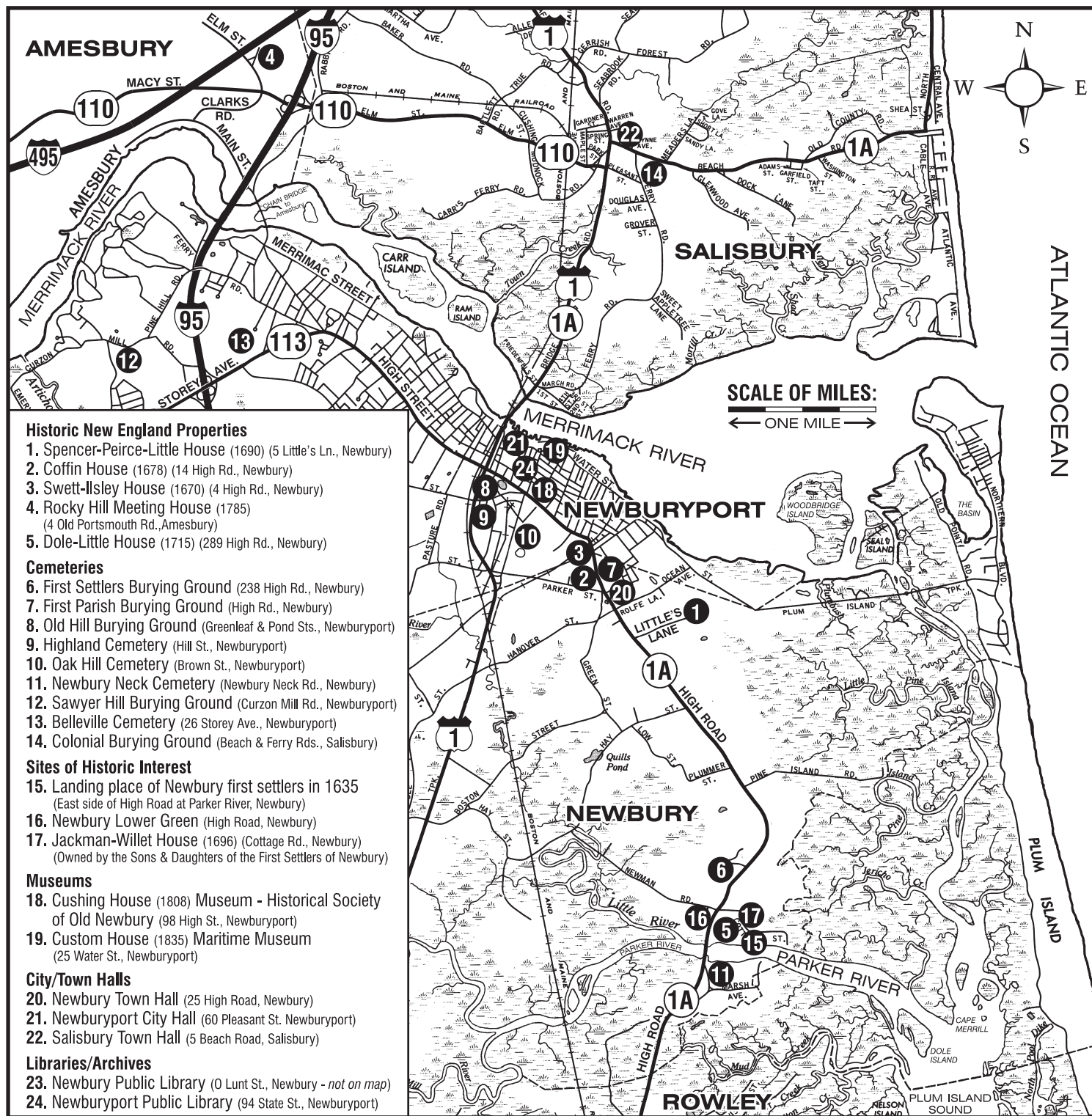

Historic New England Properties

1. Spencer-Peirce-Little House (1690) (5 Little's Ln., Newbury)
2. Coffin House (1678) (14 High Rd., Newbury)
3. Swett-Ilisley House (1670) (4 High Rd., Newbury)
4. Rocky Hill Meeting House (1785)
(4 Old Portsmouth Rd., Amesbury)
5. Dole-Little House (1715) (289 High Rd., Newbury)

Cemeteries

6. First Settlers Burying Ground (238 High Rd., Newbury)
7. First Parish Burying Ground (High Rd., Newbury)
8. Old Hill Burying Ground (Greenleaf & Pond Sts., Newburyport)
9. Highland Cemetery (Hill St., Newburyport)
10. Oak Hill Cemetery (Brown St., Newburyport)
11. Newbury Neck Cemetery (Newbury Neck Rd., Newbury)
12. Sawyer Hill Burying Ground (Curzon Mill Rd., Newburyport)
13. Belleville Cemetery (26 Storey Ave., Newburyport)
14. Colonial Burying Ground (Beach & Ferry Rds., Salisbury)

Sites of Historic Interest

15. Landing place of Newbury first settlers in 1635
(East side of High Road at Parker River, Newbury)
16. Newbury Lower Green (High Road, Newbury)
17. Jackman-Willet House (1696) (Cottage Rd., Newbury)
(Owned by the Sons & Daughters of the First Settlers of Newbury)

Museums

18. Cushing House (1808) Museum - Historical Society
of Old Newbury (98 High St., Newburyport)
19. Custom House (1835) Maritime Museum
(25 Water St., Newburyport)

City/Town Halls

20. Newbury Town Hall (25 High Road, Newbury)
21. Newburyport City Hall (60 Pleasant St. Newburyport)
22. Salisbury Town Hall (5 Beach Road, Salisbury)

Libraries/Archives

23. Newbury Public Library (0 Lunt St., Newbury - *not on map*)
24. Newburyport Public Library (94 State St., Newburyport)

See other side for directions to Historic New England properties.

For directions to 22 Newbury/Newburyport area cemeteries,
consult *The Burying Grounds of Old Newbury* by Richard N. Cunningham
(Newbury, Mass.: 375th Anniversary Committee, 2005) available at www.newbury375.org.

Regional Office:
Spencer-Peirce-Little Farm
5 Little's Lane
Newbury, MA 01951
(978) 462-2634



~ Directions to Historic New England Properties ~

Directions to Historic New England's Newbury region properties from Family Genealogy Day headquarters at Spencer-Peirce-Little Farm.

Coffin House (1678) & Swett Ilsley House (1670), Newbury, Mass.

Leaving Spencer-Peirce-Little Farm on Little's Lane, turn right onto High Road (north on Rte. 1A). Continue on High Road for approximately one-half mile (past the Upper Green, with baseball field & pond on left). The Coffin House (14 High Road) is on the left, just past the First Parish Church of Newbury. Park along either side of High Road. (The First Parish Burying Ground is across the street from the Coffin House.)

The Swett-Ilsley House, at 4 High Road, is on the same side of the street as the Coffin House, just 150 yards away to the northwest at the Newbury/Newburyport line.

Rocky Hill Meeting House (1785), Amesbury, Mass.

Leaving Spencer-Peirce-Little Farm on Little's Lane, turn right onto High Road (north on Rte. 1A). Continue on High Road from Newbury into Newburyport, where the street becomes High Street. Proceed on High Street, bearing left as the road becomes Storey Avenue (Rte. 113). Proceed on Storey Avenue past the shopping plazas to Rte. 95. (Distance from Little's Lane to Rte. 95: 3.7 miles.) Take Rte. 95 north for one exit to Rte. 110 west (Amesbury). Take the first right after the exit ramp onto Elm Street towards downtown Amesbury. Proceed on Elm Street for 0.4 miles. Rocky Hill Meeting House is on the right, facing Elm Street from the dead-end Old Portsmouth Road. Park along either side of the dead-end Old Portsmouth Road.

Directions to Sites of Interest in the Vicinity of Newbury's Lower Green

First Settlers Burying Ground

Newbury Lower Green

Jackman-Willet House (1696) (Sons & Daughters of the First Settlers of Newbury; closed for tours)

Dole-Little House (1715) (Historic New England Study Property; closed for tours)

Landing Place of the First Settlers

Leaving Spencer-Peirce-Little Farm on Little's Lane, turn left onto High Road (south on Rte. 1A). Proceed on High Road (Rte. 1A) for 2.3 miles to the Newbury Lower Green. **The First Settlers Burying Ground** is .25 miles north of the Lower Green on the west side of Rte. 1A. **The Jackman-Willet House** (owned by the Sons & Daughters of the First Settlers of Newbury, Mass.) is on Cottage Street opposite the Lower Green, about 150 yards east of Rte. 1A. **The Dole-Little House**, a Historic New England study property, is on the east side of Rte. 1A, about 100 yards past the Lower Green. **The Landing Place of the First Settlers** marker is on the east side of Rte. 1A about 200 yards south of the Lower Green near the Parker River boat ramp.



Family Genealogy Day at SPENCER-PEIRCE-LITTLE FARM

Newbury, Massachusetts



~ Known Residents at Spencer-Peirce-Little Farm 1690-1994 ~

This list of known residents is compiled from information in the *Spencer-Peirce-Little Farm Guide Manual*, which in turn derives its content from the years of prior research by Historic New England (SPNEA). This varied research cites vital records, town records, county land & probate records, census records, family genealogies, published local histories, social history reports, oral history reports, and the SPL Farm Historic Structures Report.

Despite the long list, there may be a longer list of those who lived on the farm that are simply unidentified. Before the 1850 federal census, all individuals were not enumerated by name, only the head of the household. Therefore the many dozens of tenant farmer families through the decades are unidentified. After 1850, the census provides names of individuals, but nevertheless it is merely a once-a-decade “snapshot” of who was living at the farm. The dozens of resident servants and farm laborers who came and went during the in-between years are not recorded.

Keep in mind that the stone house was built c. 1690. Before that there was most likely some kind of dwelling on the site, but we do not know for certain. Therefore the names on the list before 1690 *may or may not* have resided at the farm, but we cannot say with certainty. We do know that the Peirce family owned a house at the “waterside,” near the foot of the present Federal Street in Newburyport), which was their primary residence. – **R.W. Bacon**

*If you have information on other probable SPL Farm residents,
please share it with us.*

Residence..Name.....Birth/Death.....Relationship/Occupation.....Evidence.....

Owner 1635-1648:

(John Spencer was granted a house lot at the Lower Green and a 400-acre farm in 1635. He returned to England, leaving provisions for the farm, and hiring a man to tend his livestock. It is unclear if John Spencer – or anyone – ever lived at the farm during this period. John Spencer died in London in 1648.)

?John Spencer(b. 1604 - d. 1648).....Owner 1635-1648.....Ownership Record
1638John Godfrey(b. ?)Livestock Tender Quarterly Court Records, Essex Cty.
1645-1651Thomas Coleman(b. 1602 - d. 1685)Tenant Farmer HNE Research-1995 (Mary Beaudry)

Owner 1648-1651:

(Upon his death in 1648, the above John Spencer left the Newbury property to his nephew, John Spencer, a minor residing in Boston. In 1651 he sold the last of his uncle’s Newbury property. He died in East Greenwich, R.I. in 1684. While there may have been some structures built at the farm by 1651, the identity of who may have lived at the farm in this early period is unknown.)

?John Spencer(b. 16?? - d. 1684)Owner 1648-1651.....Ownership Record

Owner Family 1651-1677:

(While Daniel Peirce, Sr., a blacksmith, purchased the farm in 1651, it is unknown if he lived at the farm, since he did own a house on Chandler’s Lane, now Federal Street, Newburyport, near Water Street. From 1665-1670 he was in Woodbridge, N.J., where he organized and began a new settlement along with other Newbury families. In the inventory of property taken after his death, the farm is described as having “housing, barns, and orchard.” The inventory included livestock, household and farm equipment, and “negroes worth 60 pounds,” – two or three slaves according to the research for Historic New England by Mary Beaudry in 1995.)

?Daniel Peirce, Sr.(b. 1611 - d. 1677).....Owner 1651-1677.....Ownership Record
?Sarah (?) Peirce(b. ? - d. 1654).....1st Wife (m. 1638) of D. Peirce, Sr.Peirce Genealogy
?Anne (Goodale) (Milward) Peirce ... (b. 1600 - d. 1690).....2nd Wife (m. 1654) of D. Peirce, Sr.Peirce Genealogy
?Daniel Peirce(b. 1638 - d. 1704).....Son of D. Peirce, Sr.Peirce Genealogy
?Sarah Peirce(b. 1640 - d. 1665).....Daughter of D. Peirce, Sr.Peirce Genealogy
?Joshua Peirce(b. 1642 - d. 1671).....Son of D. Peirce, Sr.Peirce Genealogy
?Martha Peirce(b. 1649 - ?).....Daughter of D. Peirce, Sr.Peirce Genealogy
Plus children of Anne (Goodale) Milward and her late husband Thomas Milward (1600-1653) in combined household 1654 on:
?Ann Milward(b. 1642 - ?).....Step-Daughter of D. Peirce, Sr.Peirce Genealogy
?Rebecca Milward(b. 1643 - d. 1677).....Step-Daughter of D. Peirce, Sr.Peirce Genealogy
?Elizabeth Milward.....(b. 1644 - d. 1709).....Step-Daughter of D. Peirce, Sr.Peirce Genealogy

Plus:
?Two or three unidentified slaves.....Inventory of Daniel Peirce, Sr. Estate, 1677

Family Genealogy Day at SPENCER-PEIRCE-LITTLE FARM

Newbury, Massachusetts



~ Known Residents at Spencer-Peirce-Little Farm 1690-1994, page 2 ~

Residence..Name.....Birth/Death.....Relationship/Occupation.....Evidence.....

Owner Family 1677-1704:

(Daniel Peirce, Jr., a blacksmith known as "Col. Daniel Peirce," is believed to have built the stone house at SPL Farm about 1690. He also owned a house on the south side of Chandler's Lane, now Federal Street, Newburyport, near Water Street.)

1690-1704.....Daniel Peirce, Jr.	(b. 1638 - d. 1704).....	Owner 1677-1704.....	Ownership Record
1690-1704.....Elizabeth (Milward) Peirce.....	(b. 1644 - d. 1709).....	Wife & Step-Sister of D. Peirce, Jr.	Peirce Genealogy
1690-1704.....Daniel Peirce III.....	(b. 1663 - d. 1690).....	Son of D. Peirce, Jr.	Peirce Genealogy
1690-1705.....Anne Peirce.....	(b. 1666 - ?).....	Daughter of D. Peirce, Jr.	Peirce Genealogy
1690-1711.....Benjamin Peirce.....	(b. 1669-1711).....	Son of D. Peirce, Jr.	Peirce Genealogy
1690-1705.....Joshua Peirce.....	(b. 1671 - ?).....	Son of D. Peirce, Jr.	Peirce Genealogy
1690-1705.....Thomas Peirce.....	(b. 1674 - ?).....	Son of D. Peirce, Jr.	Peirce Genealogy
1690-1704.....Martha Peirce.....	(b. 1676 - d. 1732).....	Daughter of D. Peirce, Jr.	Peirce Genealogy
1690-1704.....Sarah Peirce.....	(b. 1679 - ?).....	Daughter of D. Peirce, Jr.	Peirce Genealogy
1690-1704.....George Peirce.....	(b. 1682 - ?).....	Son of D. Peirce, Jr.	Peirce Genealogy
1690-1704.....Mary Peirce.....	(b. 1685 - ?).....	Daughter of D. Peirce, Jr.	Peirce Genealogy
1690-1704.....John B. Peirce.....	(b. 1687 - ?).....	Son of D. Peirce, Jr.	Peirce Genealogy
1690-1704.....Catherine Peirce.....	(b. 1690 - ?).....	Daughter of D. Peirce, Jr.	Peirce Genealogy

Owner Family 1704-1711:

1704-1711.....Benjamin Peirce.....	(b. 1669 - d. 1711).....	Owner 1704-1711.....	Ownership Record
1704-1711.....Lydia (Frost) Peirce.....	(b. 1674 - d. 1752).....	Wife of D. Peirce, Jr.	Peirce Genealogy
1704-1711.....Daniel Peirce.....	(b. 1693 - d. 1693).....	Son of D. Peirce, Jr.	Peirce Genealogy
1704-1711.....Charles Peirce.....	(b. 1694 - d. 1764).....	Son of D. Peirce, Jr.	Peirce Genealogy
1704-1711.....Elizabeth Peirce.....	(b. 1696 - ?).....	Daughter of D. Peirce, Jr.	Peirce Genealogy
1704-1711.....Daniel Peirce.....	(b. 1698 - d. 1729).....	Son of D. Peirce, Jr.	Peirce Genealogy
1704-1711.....Benjamin Peirce.....	(b. 1700 - ?).....	Son of D. Peirce, Jr.	Peirce Genealogy
1704-1711.....John Peirce.....	(b. 1793 - ?).....	Son of D. Peirce, Jr.	Peirce Genealogy
1704-1711.....Humphrey Peirce.....	(b. 1706 - ?).....	Son of D. Peirce, Jr.	Peirce Genealogy
1704-1711.....Joseph Peirce.....	(b. 1708 - ?).....	Son of D. Peirce, Jr.	Peirce Genealogy
1704-1711....."One Negro Man Slave".....			Inventory of Benjamin Peirce Estate, 1713

Owner Family 1711-1764:

1711-1764.....Charles Peirce.....	(b. 1694 - d. 1764).....	Owner 1711-1764.....	Ownership Record
1718-?.....Sarah (Frost) Peirce.....	(b. 1699 - d. ?).....	Wife of C. Peirce.....	Peirce Genealogy
1719-1772.....Charles Peirce.....	(b. 1719 - d. ?).....	Son of C. Peirce.....	Peirce Genealogy
1721-?.....Jane Peirce.....	(b. 1721 - d. ?).....	Daughter of C. Peirce.....	Peirce Genealogy
1723-?.....Benjamin Peirce.....	(b. 1723 - d. ?).....	Son of C. Peirce.....	Peirce Genealogy
1725-?.....Lydia Peirce.....	(b. 1725 - d. ?).....	Daughter of C. Peirce.....	Peirce Genealogy
1731-?.....William Peirce.....	(b. 1731 - d. ?).....	Son of C. Peirce.....	Peirce Genealogy
1733-?.....Simon Peirce.....	(b. 1733 - d. ?).....	Son of C. Peirce.....	Peirce Genealogy
1739-?.....Daniel Peirce.....	(b. 1739 - d. ?).....	Son of C. Peirce.....	Peirce Genealogy

Owner Family 1764-1772:

1764-1772.....Charles Peirce, Jr.	(b. 1719 - d. 1772).....	Owner 1764-1772.....	Ownership Record
1759-1760.....Mary (Feveryear) Peirce.....	(b. 1738 - d. 1760).....	Wife of C. Peirce, Jr.	Peirce Genealogy
1769-1772.....Sarah Peirce.....	(b. 1760 - d. ?).....	Daughter of C. Peirce, Jr.	Peirce Genealogy

Owner Family 1772-1778:

(When Charles Peirce, Jr. died in 1772 without a direct male heir, the property went to his next-closest male heirs, his nephews. They were not interested in living on the property, and divided it into two parcels in 1778. Nathaniel Tracy purchased both sections and reunited the property. It appears that Daniel Peirce and William Peirce never resided at the farm.)

1772-1778.....Daniel Peirce & William Peirce.....	Owners 1772-1778.....	Ownership Record
---	-----------------------	------------------

Owner Family 1778-1797:

(Merchant and Revolutionary War privateer Nathaniel Tracy lived in a mansion on State Street, Newburyport, which since 1854 has housed the Newburyport Public Library. From 1781-1786, Nathaniel Tracy also lived in what came to be known as the Longfellow House in Cambridge, Mass. He "retired" to the farm after financial reversals in 1786.)

1778-1797.....Nathaniel Tracy.....	(b. 1751 - d. 1796).....	Owner 1777-1797.....	Ownership Record
1778-1797.....Mary (Lee) Tracy.....	(b. 1753 - d. 1819).....	Wife of N. Tracy.....	Tracy Genealogy
1778-1797.....Hannah Tracy.....	(b. 1776 - d. 1823).....	Daughter of N. Tracy.....	Tracy Genealogy
1778.....Martha L. Tracy.....	(b. 1777 - d. 1778).....	Daughter of N. Tracy.....	Tracy Genealogy
1780-1797.....Patrick Tracy.....	(b. 1780 - d. 1819).....	Son of N. Tracy.....	Tracy Genealogy
1781-1788.....Nathaniel Tracy.....	(b. 1781 - d. 1788).....	Son of N. Tracy.....	Tracy Genealogy

Family Genealogy Day at SPENCER-PEIRCE-LITTLE FARM

Newbury, Massachusetts



~ Known Residents at Spencer-Peirce-Little Farm 1690-1994, page 3 ~

Residence..Name.....	Birth/Death.....	Relationship/Occupation.....	Evidence.....
1782-1797.....Jeremiah L. Tracy.....	(b. 1782 - d. 1844).....	Son of N. Tracy.....	Tracy Genealogy
1786-1797.....Mary Tracy.....	(b. 1786 - d. 1809).....	Daughter of N. Tracy.....	Tracy Genealogy
1787-1797.....Louisa L. Tracy.....	(b. 1787 - d. 1869).....	Daughter of N. Tracy.....	Tracy Genealogy
1788.....Nathaniel Tracy.....	(b. 1788 - d. 1788).....	Son of N. Tracy.....	Tracy Genealogy
1791-1797.....Martha Tracy.....	(b. 1791 - d. 1819).....	Daughter of N. Tracy.....	Tracy Genealogy
1796-1797.....Helen Tracy.....	(b. 1796 - d. 1865).....	Daughter of N. Tracy.....	Tracy Genealogy
1786.....Thomas Butman.....	Occupied farm during temporary transfer to Thomas Russell.....		HNE Research-1993
1786.....Cupid Lee (Free African-American).....	Occupied farm during temporary transfer to T. Russell.....		HNE Research-1993
1790-?.....Jeremiah Lee.....	(b. 1763 - d. 1792).....	Brother of Mary (Lee) Tracy.....	Tracy Genealogy
1790-?.....Lucy Temple.....	(b. 1785).....	Niece of Mary (Lee) Tracy.....	Tracy Genealogy
1790 Federal Census: 3 males over 16; 3 males under 16; 5 females; no slaves.....			1790 Federal Census

Owner Family 1797-1813:

1797-1811.....Offin Boardman IV.....	(b. 1748 - d. 1811).....	Owner 1797-1813.....	Ownership Record
1797-1813.....Sarah (Tappan) Boardman.....	(b. 1745 - d. ?).....	Wife of O. Boardman IV.....	Boardman Genealogy
1797-1798.....Hannah C. Boardman.....	(b. 1775 - d. 1832).....	Daughter of O. Boardman IV.....	Boardman Genealogy
1797-1805.....Benjamin G. Boardman.....	(b. 1783 - d. ?).....	Son of O. Boardman IV.....	Boardman Genealogy
1797-1810.....Susan G. Boardman.....	(b. 1788 - d. 1862).....	Daughter of O. Boardman IV.....	Boardman Genealogy
1803-1805.....Offin Boardman V.....	(b. 1777 - d. 1836).....	Son of O. Boardman IV.....	Boardman Genealogy
1803-1805.....Judith (Boardman) Boardman.....	(b. 17?? - d. 1855).....	Wife of O. Boardman V.....	Boardman Genealogy
1803-1805.....Sarah T. Boardman.....	(b. 1803 - d. 1879).....	Daughter of O. Boardman V.....	Boardman Genealogy
1805-1805.....Rebecca M. Boardman.....	(b. 1805 - d. 1834).....	Daughter of O. Boardman V.....	Boardman Genealogy
1800-180?.....J. Tm (Thomas?).....	(b. ?).....	Farmer.....	Diary of O. Boardman IV
1800-180?.....Thomas Taylor.....	(b. ?).....	Farmer.....	Diary of O. Boardman IV
1799-180?.....Moses Boardman (or Adams).....	(b. ?).....	Farmer.....	Diary of O. Boardman IV
1799-180?.....Phoebe (?) Adams.....	(b. ?).....	Wife of Moses Boardman (Adams).....	Diary of O. Boardman IV
1800 Federal Census: 2 males 10-16; 1 male 16-26; 1 male over 45; 3 females 10-16; 1 female over 45.....			1800 Federal Census
1810 Federal Census: 1 male 16-26; 1 male over 45; 2 females 16-26; 1 female over 45.....			1810 Federal Census

Owner Family 1813-1827:

(Shipbuilder/merchant John Pettingell was never a full-time resident at the farm, but was known to stay at the farm during the summer. In 1792 he built a large home at 180 High Street at the corner of Winter St., Newburyport, where he lived until his death in 1827.)

1813-1827.....John Pettingell.....	(b. 1745 - d. 1827).....	Owner 1813-1827 (summer only).....	Ownership Record
1813-1827.....Sarah (Smith) Pettingell.....	(b. 1751 - d. 1836).....	Wife of J. Pettingell (summer only).....	Pettingell Genealogy
1820 Federal Census (Newburyport household): 1 male 16-26; 1 male over 45; 1 female 26-45; 1 female over 45.....			1820 Federal Census

Owner Family 1827-1861:

1827-1861.....Pettingell heirs engaged laborers in a "sharecropper" lease arrangement to operate the farm.....			Ownership Record
1830-1840-1850 Federal Census: Unable to determine who may have lived at the farm during this period.....			

Owner Family 1861-1877:

(Edward H. Little leased the farm from the Pettingell owners in 1851, and purchased the farm outright in 1861.)

1851-1877.....Edward H. Little.....	(b. 1819 - d. 1877).....	Owner 1861-1877.....	Ownership Record
1851-1923.....Catherine (Little) Little.....	(b. 1824 - d. 1923).....	Wife of E.H. Little.....	Little Genealogy
1851-187?.....Henry B. Little.....	(b. 1851 - d. 1957).....	Son of E.H. Little.....	Little Genealogy
1853-1935.....Edward F. Little.....	(b. 1853 - d. 1935).....	Son of E.H. Little.....	Little Genealogy
1856-1857.....William W. Little.....	(b. 1856 - d. 1857).....	Son of E.H. Little.....	Little Genealogy
1858-1912.....Daniel N. Little.....	(b. 1858 - d. 1912).....	Son of E.H. Little.....	Little Genealogy
1861-1959.....Eliza A. Little.....	(b. 1861 - d. 1959).....	Daughter of E.H. Little.....	Little Genealogy

Resident Servants & Laborers - 1850-70 Census:

1855.....Mary Creder.....	(b. 1835, Ireland).....	Domestic Servant.....	1855 State Census
1855.....John Quill.....	(b. 1822, Ireland).....	Laborer.....	1855 State Census
1855.....Jesse Coffee.....	(b. 1842, Ireland).....	Laborer.....	1855 State Census
1855.....George W. Pilsbury.....	(b. 1831, Maine).....	Laborer.....	1855 State Census
1860.....Charles Little.....	(b. 1841, Mass.).....	Farm Laborer.....	1860 Federal Census
1860.....Fran Pilsbury.....	(b. 1841, Maine).....	Farm Laborer.....	1860 Federal Census
1860.....Owin Keep.....	(b. 1820, Ireland).....	Farm Laborer.....	1860 Federal Census
1860.....Jane Coshery.....	(b. 1820, Ireland).....	Domestic Servant.....	1860 Federal Census
1865.....Margaret Cummins.....	(b. 1845).....	Domestic Servant.....	1865 State Census
1870.....Lydia (?).....	(b. 1831, Mass.).....	Boarder.....	1870 Federal Census
1870.....Samuel Coatis.....	(b. 1849, Canada).....	Farm Laborer.....	1870 Federal Census

Family Genealogy Day at SPENCER-PEIRCE-LITTLE FARM

Newbury, Massachusetts



~ Known Residents at Spencer-Peirce-Little Farm 1690-1994, page 4 ~

Residence..Name.....Birth/Death.....Relationship/Occupation.....Evidence.....

Owner Family 1877-1935:

1853-1935.....Edward F. Little(b. 1853 - d. 1935).....Son of E.H. Little; owner 1877-1935.....Ownership Record
 ?-1921Sarah (Adams) Little(b. 1854 - d. 1921).....Wife of E.F. Little.....Little Genealogy
 1896-1982.....Agnes L. Little.....(b. 1896 - d. 1982).....Daughter of E.F. Little; owner 1954-82.....Ownership Record

Owner Family 1877-1912:

1858-1912.....Daniel N. Little.....(b. 1858 - d. 1912).....Son of E.H. Little; owner 1877-1912.....Ownership Record
 1885-1903.....Amelia (Bradley) Little.....(b. 1863 - d. 1903).....Wife of D.N. Little.....Little Genealogy
 1886-1907.....Katherine R. Little.....(b. 1886 - d. 1907).....Daughter of D.N. LittleLittle Genealogy
 1888-192?.....Margaret B. Little(b. 1888 - d. 1967).....Daughter of D.N. LittleLittle Genealogy
 1890-1917.....Frances E. Little(b. 1890 - d. 1917).....Daughter of D.N. LittleLittle Genealogy
 1894-192?.....Albert N. Little(b. 1894 - d. 1976).....Son of D.N. LittleLittle Genealogy

Resident Servants & Laborers - 1880 Census:

1880.....Mary Casey(b. 1855, Ireland).....Domestic Servant1880 Federal Census
 1880.....Jere Kelleher(b. 1857, Ireland).....Farm Laborer1880 Federal Census
 1880.....Patrick Burns(b. 1859, Ireland).....Farm Laborer1880 Federal Census
 1880.....John Burns(b. 1857, Ireland).....Farm Laborer1880 Federal Census
 1880.....Daniel Casey.....(b. 1853, Ireland).....Farm Laborer1880 Federal Census
 1880.....George Lowery(b. 1859, Mass.)Farm Laborer1880 Federal Census

Resident Servants & Laborers - 1900 Census:

1900.....Hannah Sullivan(b. 1876, Ireland).....Domestic Servant1900 Federal Census
 1900.....Mary Gavin.....(b. 1877, Ireland).....Domestic Servant1900 Federal Census
 1900.....John Murphy(b. 1861, Ireland).....Farm Laborer1900 Federal Census
 1900.....John Sullivan(b. 1871, Ireland).....Farm Laborer1900 Federal Census
 1900.....John Herlihy(b. 1868, Ireland).....Farm Laborer1900 Federal Census

Resident Servants & Laborers - 1910 Census:

1910.....Hannah Myers.....(b. 1882, Canada)Servant1910 Federal Census
 1910.....William Grand.....(b. 1888, Russia/Lithuania)Hired Man.....1910 Federal Census
 1910.....Clement Virguiage(b. 1888, Russia/Lithuania)Hired Man.....1910 Federal Census
 1910.....John Bamack.....(b. 1882, Russia/Lithuania)Hired Man.....1910 Federal Census

Resident Servants & Laborers - SPL Oral History Report:

c. 1910-20Mrs. Lynch.....(b. Ireland).....Cook.....SPL Oral History Report
 1913-1924.....two maids(b. Finland).....Domestic Servants.....SPL Oral History Report
 c. 1918two German prisoners(b. Germany)Farm LaborersSPL Oral History Report

Owner Family 1935-1986:

(In 1971 cousins Agnes Little & Amelia Little deeded the property to the Society for the Preservation of New England Antiquities (SPNEA - now Historic New England), reserving life tenancy for themselves and the Stekionis family.)

1861-1959.....Eliza A. Little(b. 1861 - d. 1959).....Daughter of E.H. Little; owner 1935-54 ...Ownership Record
 1896-1982.....Agnes L. Little.....(b. 1896 - d. 1982).....Daughter of E.F. Little; owner 1954-82.....Ownership Record
 1892-1986.....Amelia W. Little.....(b. 1892 - d. 1986).....Daughter of D.N. Little; owner 1954-86...Ownership Record

Tenant Farmer Family 1913-1994 / Farm Manager 1935-1984:

1912-1984.....Jacob Stekionis.....(b. 1891, Lithuania - d. 1984).....Farmer1920-30 Census; SPL Social History Report
 1924-1994.....Dorothy (?) Stekionis(b. 1899, Lithuania - d. 1994).....Wife of J. StekionisSPL Social History Report
 Private.....Olga Stekionis(b. 1925 - d. 2015).....Daughter of J. StekionisSPL Social History Report
 Private.....Nancy Stekionis(b. living-private)Daughter of J. StekionisSPL Social History Report
 Private.....Mary Stekionis(b. living-private)Daughter of J. StekionisSPL Social History Report

###



HISTORIC
NEW ENGLAND

Defining the past. Shaping the future.

Regional Office:
Spencer-Peirce-Little Farm
5 Little's Lane
Newbury, MA 01951
(978) 462-2634

~ Plan of the Original Settlement at the Lower Green, Newbury, Mass., 1635 ~

The plan below is adapted for readability and reference from a plan drawn in 1862 – which was itself adapted from a plan drawn in 1828 by Daniel Dole. It is important to note that the scale of the original plan is unknown, and pinpointing original lot locations is difficult at best.

Note on the 1862 map by its unknown creator: “as deduced from the Town Records by Dan’l Dole in 1828 with some modifications, from a map of the town, made in 1830. – 1862”

NOTES:

- (1) “Merrimac Street” on this plan is likely the location of the present High Road (Rte. 1A).
- (2) “High Street” on this plan may or may not be the location of the present Newman Road. Superimposing the plan on an aerial photo of the area is inconclusive.
- (3) The page numbers refer to the location of records in the Newbury “Proprietors Books.”
- (4) If the proportions and lot sizes on the 1862 drawing were accurately represented, the scale of this plan would be one inch = .10 (1/10) miles (or alternatively, 10"=1 mile).

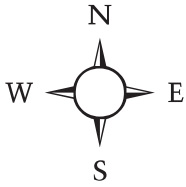
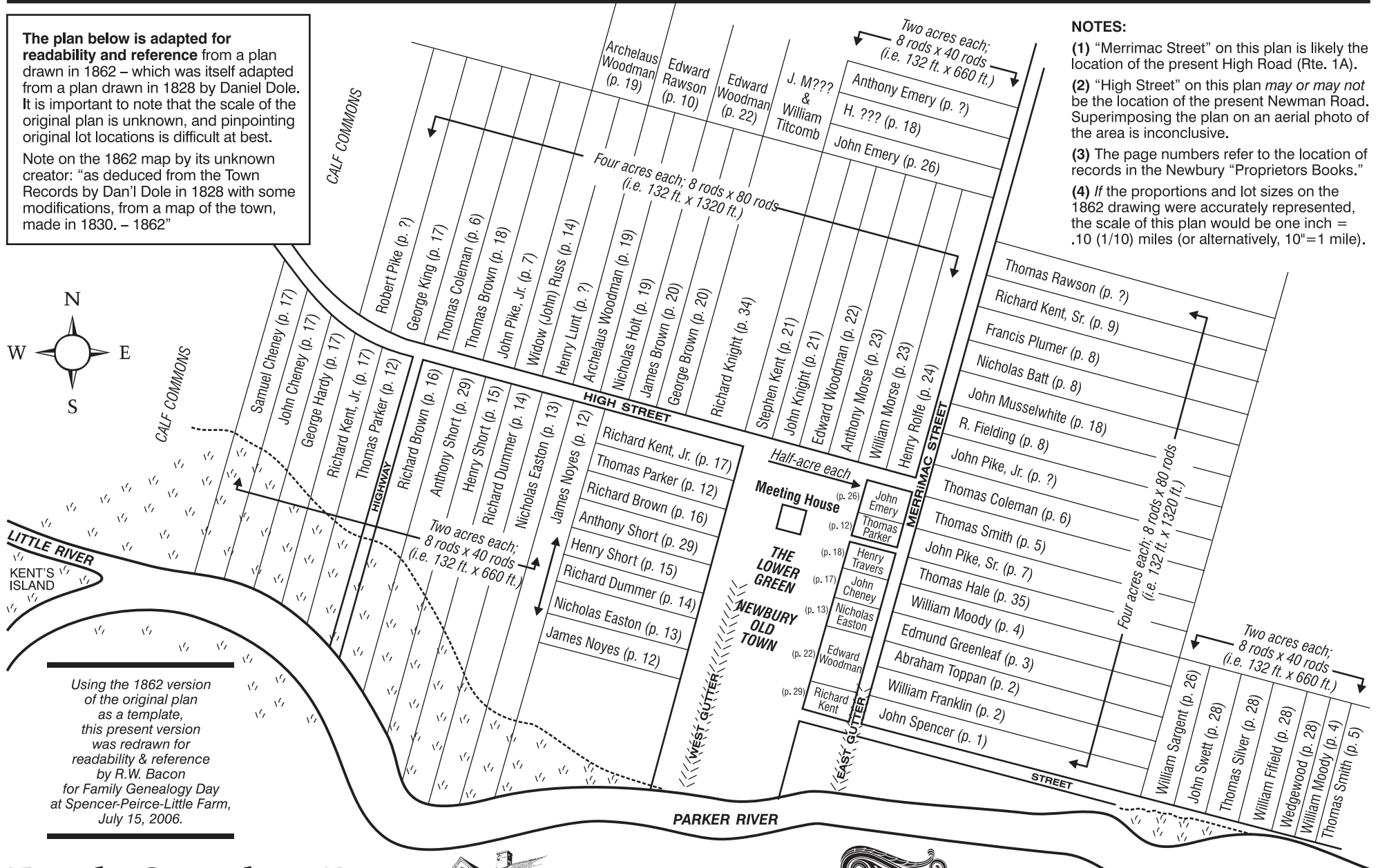

Using the 1862 version of the original plan as a template, this present version was redrawn for readability & reference by R.W. Bacon for Family Genealogy Day at Spencer-Peirce-Little Farm, July 15, 2006.

Family Genealogy Day
at
SPENCER-PEIRCE-LITTLE FARM
Newbury, Massachusetts



HISTORIC NEW ENGLAND
Defining the past. Shaping the future.

Regional Office:
Spencer-Peirce-Little Farm
5 Little's Lane, Newbury, MA 01951
(978) 462-2634 • www.HistoricNewEngland.org

Family Genealogy Day at SPENCER-PEIRCE-LITTLE FARM

Newbury, Massachusetts



~ First Settlers Burying Ground, Newbury, Mass. ~

The First Settlers Burying Ground was established in 1635 adjacent to the first meeting house just north of the Newbury Lower Green. As with most of early cemeteries of that era, precise records of burials are few, and grave markers have deteriorated to varying degrees. According to Richard N. Cunningham's invaluable guide to Newbury area cemeteries (*The Burying Grounds of Old Newbury*, Newbury 375th Anniversary Committee, 2005), "No information is available on who, when, and where the first burials were made there." A number of graves are marked with unlettered fieldstones.

During a recent visit, 52 stones were counted. Of this number, 18 were reproduction "in memory of" stones that have been placed by descendants, 21 were worn to an unreadable state, and 13 were readable original markers.

The First Settlers Burying Ground has endured long periods of neglect, but is now in much improved condition thanks to the efforts of Newbury historian Richard Cunningham and family. Use of the burial ground began to decline in the mid-1640s when the center of Newbury activity shifted to the Upper Green area. Over the centuries the cemetery became overgrown, and the ownership of the land was in question, as it was next to a working farm. When the Sons & Daughters of the First Settlers of Newbury, Mass. was formed in 1927, one of the early members, Jane Dole Moore of New York, took an interest in the burying ground. With her initiative working with the Newbury board of selectmen, the town acquired the property, installed granite gateposts, and mounted a bronze plaque. When Jane Dole Moore died in 1940, she left \$1000 to be held in trust for cemetery maintenance. Today the cemetery is under the care of the Trustees of the First Settlers Burial Ground.

Directions: From the end of Little's Lane at SPL Farm, turn left onto Rte. 1A south. Proceed two miles and look for a small white sign on the right. The burying ground is set back from the road about 100 ft., where you will see the granite posts. (Make sure to take along mosquito repellent, as Newbury marsh mosquitos are known for their size and voraciousness!)

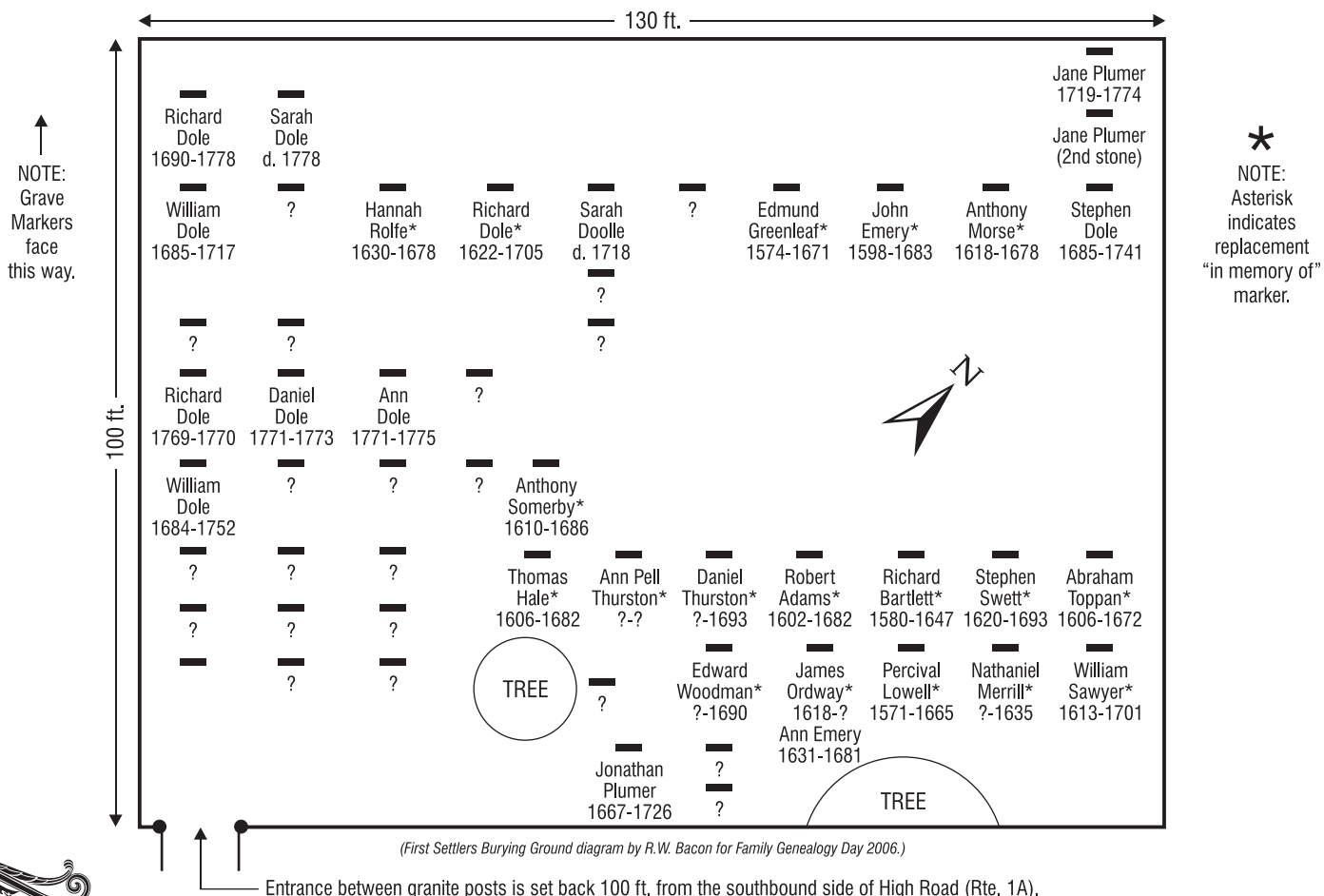

Family Genealogy Day at SPENCER-PEIRCE-LITTLE FARM

Newbury, Massachusetts



~ First Parish Burying Ground, Newbury, Mass. ~

The **First Parish Burying Ground** was established in 1646 when a new meeting house was built to serve the growing population at the Newbury Upper Green. Four meeting houses were built on the site, the last destroyed by fire in 1868. The following year the present First Parish Church was built across the street from the cemetery and former meeting house site.

The cemetery is the resting place of six generations of the Coffin family who occupied the house across the street built in 1678 which now a historic house museum owned by Historic New England. Throughout the cemetery are all the familiar names of early Newbury families: Adams, Atkinson, Brown, Gerrish, Dodge, Greenleaf, Hale, Ilsley, Knight, Little, Lunt, Moody, Parker, Peirce, Poore, Sargent, Stickney, Tappan, Thurlow, Woodbridge, Woodman, Woodwell, and many, many more.

Directions: From the end of Little's Lane at SPL Farm, turn right onto Rte. 1A north. Proceed for one-half mile and look for the cemetery on the right. The cemetery is across the street from the First Parish Church and the Coffin House.

~ Burial Locations of Property Owners ~

Spencer-Peirce-Little Farm – Coffin House – Swett-Ilsley House – Dole-Little House

Name	Birth/Death	Ownership	Cemetery	City/Town
Spencer-Peirce-Little Farm Owners:				
John Spencer	(b. 1604 - d. 1648)	1635-1648		d. London, England
John Spencer	(b. 16?? - d. 1684)	1648-1651	unmarked family plot near Payne's Pond	East Greenwich, R.I.
Daniel Peirce, Sr.	(b. 1611 - d. 1677)	1651-1677		unknown
Daniel Peirce, Jr.	(b. 1638 - d. 1704)	1677-1704	First Parish Burying Ground	Newbury, Mass.
Benjamin Peirce	(b. 1669 - d. 1711)	1704-1711	First Parish Burying Ground	Newbury, Mass.
Charles Peirce	(b. 1694 - d. 1764)	1711-1764	First Parish Burying Ground	Newbury, Mass.
Charles Peirce, Jr.	(b. 1719 - d. 1772)	1764-1772	First Parish Burying Ground	Newbury, Mass.
Daniel Peirce & William Peirce		1772-1777		unknown
Nathaniel Tracy	(b. 1751 - d. 1796)	1777-1797	Old Hill Burying Ground	Newburyport, Mass.
Offin Boardman	(b. 1748 - d. 1811)	1797-1813	Highland Cemetery	Newburyport, Mass.
John Pettingell	(b. 1745 - d. 1827)	1813-1827	Highland Cemetery	Newburyport, Mass.
Pettingell heirs		1827-1861		unknown
Edward H. Little	(b. 1819 - d. 1877)	1861-1877	First Parish Burying Ground	Newbury, Mass.
Edward F. Little	(b. 1853 - d. 1935)	1877-1935	Oak Hill Cemetery	Newburyport, Mass.
Daniel N. Little	(b. 1858 - d. 1912)	1877-1912	Oak Hill Cemetery	Newburyport, Mass.
Eliza A. Little	(b. 1861 - d. 1954)	1935-1954	Oak Hill Cemetery	Newburyport, Mass.
Agnes L. Little	(b. 1896 - d. 1982)	1954-1982	Oak Hill Cemetery	Newburyport, Mass.
Amelia W. Little	(b. 1892 - d. 1986)	1954-1986	Oak Hill Cemetery	Newburyport, Mass.
Coffin House Owners:				
Tristram Coffin, Jr.	(b. 1632 - d. 1704)	1678-1705	First Parish Burying Ground	Newbury, Mass.
Nathaniel Coffin	(b. 1669 - d. 1749)	1705-1749	First Parish Burying Ground	Newbury, Mass.
Joseph Coffin	(b. 1702 - d. 1773)	1749-1773	First Parish Burying Ground	Newbury, Mass.
Joshua Coffin	(b. 1732 - d. 1774)	1773-1774	First Parish Burying Ground	Newbury, Mass.
After 1785 property division - Original 1678 House:				
Joseph Coffin	(b. 1762 - d. 1805)	1774-1805	First Parish Burying Ground	Newbury, Mass.
Joshua Coffin	(b. 1792 - d. 1864)	1809-1864	First Parish Burying Ground	Newbury, Mass.
Anna Chase Coffin	(b. 1801 - d. 1876)	1864-1876	First Parish Burying Ground	Newbury, Mass.
Anna L. Coffin	(b. 1838 - d. ?)	1876-1883		unknown
Edmund C. Colman	(b. 1841 - d. 1915)	1883-1915		unknown
After 1785 property division - Front Range 1712 House:				
Edmund Coffin	(b. 1764 - d. 1825)	1774-1825	First Parish Burying Ground	Newbury, Mass.
Lucy Coffin	(b. 1811 - d. 1893)	1825-1893	First Parish Burying Ground	Newbury, Mass.
Margaret C. Merriam	(b. 1811 - d. 1893)	1893-1929		unknown
Swett-Ilsley House Original Owner:				
Stephen Swett	(b. 1620 - d. 1693)	1670-1691	First Settlers Burying Ground	Newbury, Mass.
Dole-Little House Original Owner:				
Richard Dole, Jr.	(b. 1650 - d. 1723)	1715-1723	unknown - most likely unmarked in First Settlers Burying Ground	
OR nephew Richard Dole	(b. 1689 - d. 1778)	1715-1778	First Settlers Burying Ground	Newbury, Mass.

Family Genealogy Day at SPENCER-PEIRCE-LITTLE FARM



Newbury, Massachusetts

~ Newbury Genealogy & Local History Resources ~

City/Town Resources (original vital records, i.e. births, deaths, marriages)

Newbury Town Hall - Clerk's Office25 High Rd., Newbury, MA 01951 • (978) 462-2332.....www.townofnewbury.org
Newburyport City Hall - Clerk's Office60 Pleasant St., Newburyport, MA 01950 • (978) 465-4407www.cityofnewburyport.com
West Newbury Town Hall - Clerk's Office.....381 Main St., W. Newbury, MA 01985 • (978) 363-1100, ext. 15 ...www.town.west-newbury.ma.us/

Public Libraries (local history & genealogy materials, access to Massachusetts vital records indexes & federal census)

Newbury Town Library0 Lunt St., Newbury, MA 01951 • (978) 465-0539www.newburylibrary.org
Newburyport Public Library Archival Ctr.....94 State St., Newburyport, MA 01950 • (978) 465-4428, ext. 229www.newburyportpl.org
West Newbury- G.A.R. Memorial Library490 Main St., West Newbury, MA 01985 • (978) 363-1105www.town.west-newbury.ma.us/

Museums (local history materials)

Cushing House Museum
(Historical Society of Old Newbury)98 High St., Newburyport, MA 01950 • (978) 462-2681.....www.newburyhist.com
Custom House Museum
(Newburyport Maritime Society)25 Water St., Newburyport, MA 01950 • (978) 462-8681www.themaritimesociety.org
Historic New England - Newbury Region (SPL Farm, Coffin House, Swett-Ilsley House, Dole-Little House, Rocky Hill Meeting House)
Spencer-Peirce-Little Farm5 Little's Ln., Newbury, MA 01951 • (978) 462-2634.....www.HistoricNewEngland.org

County Resources (probate records, deeds)

Essex County Probate Court36 Federal St., Salem, MA 01970 • (978-744-1020, ext. 383no web site at present
Essex County (South) Registry of Deeds).....36 Federal St., Salem, MA 01970 • (978) 741-0200, ext. 250.....www.salemdeeds.com
- Online Deeds (ca. 1641-1709) Essex County Registry of Deeds (Southern District)www.salemdeeds.com/historic.asp

State Resources (maps, land records, tax records, 1855 & 1865 state census)

Massachusetts State Archives220 Morrissey Blvd., Boston, MA 02125 • (617) 727-2816www.sec.state.ma.us/arc/arcidx.htm

Federal Resources (naturalization records, passenger lists, early military records, federal census 1790-1930)

National Archives (Northeast Region)380 Trapelo Rd., Waltham, MA 02452 • 781-663-0130www.archives.gov/northeast/boston/
Library of Congress (American Memory collection; photographs)www.loc.gov

Genealogical Organizations & Libraries

Sons & Daughters of the First Settlers
of Newbury, Mass.P. O. Box 444, Newburyport, MA 01950www.firstsettlersofnewbury.org
Essex Society of Genealogists.....P. O. Box 313, Lynnfield, MA 01940www.esog.org
New England Historic Genealogical Society ..101 Newbury St., Boston, MA 02116 • (617) 536-5740www.newenglandancestors.com
LDS Family History Center Branch.....400 Essex Street, Lynnfield, MA 01940 • (781) 334-5586www.familysearch.org
Phillips Library (Peabody Essex Museum).....Plummer Hall, PEM, East India Sq., Salem, MA 01970 • (866) 745-1876, ext. 3053
.....<http://www.pem.org/museum/library.php>

Neighboring City/Town Resources

Amesbury Town Hall - Clerk's Office62 Friend St., Amesbury, MA 01913 • (978) 388-8100www.ci.amesbury.ma.us
Amesbury Public Library149 Main St., Amesbury, MA 01913 • (978) 388-8148.....www.amesburylibrary.org
Salisbury Town Hall - Clerk's Office5 Beach Rd., Salisbury, MA 01952 • (978) 462-7591.....www.salisburyma.gov
Salisbury Public Library.....17 Elm St., Salisbury, MA 01952 • (978) 465-5071www.mvlc.org/Libraries/salisbur2.htm
Rowley Town Hall - Clerk's OfficeP. O. Box 351, Rowley, MA 01969 • (978) 948-2081.....www.town.rowley.ma.us/
Rowley Public Library17 Wethersfield St., Rowley, MA 01969 • (978) 948-2850www.town.rowley.ma.us/Library/

Web Sites of Local History & Genealogy Interest

Newbury 375th Anniversary Committee.....www.newbury375th.org
U.S. GenWeb Essex County (Mass.) site (multiple links)<http://www.rootsweb.com/%7Emaessex/>
Essex County (Mass.) GenConnect web site.....<http://resources.rootsweb.com/USA/MA/Essex/>



*Please see other side
for bibliography & historical sketch*

Regional Office:
Spencer-Peirce-Little Farm
5 Little's Lane
Newbury, MA 01951
(978) 462-2634



~ Newbury Genealogy & Local History Resources ~

A bibliography of Newbury local history

- Benes, Peter. *Old-Town and the Waterside: Two Hundred years of Tradition and Change in Newbury, Newburyport, and West Newbury, 1635-1835*. Newburyport, Mass.: The Historical Society of Old Newbury, 1986.
- Chick, R.W., ed. *Inventory to Old Documents and Books in the Vault of the Town Hall, Newbury, Mass.* (documentation by Historical Archives Committee 1985 - 1989). Newbury, Mass.: R.W. Chick, 1996.
- Coffin, Joshua (1792-1864). *A Sketch of the History of Newbury, Newburyport, and West Newbury*. Boston, Mass.: S.G. Drake, 1845. (Republished in 1977 by Peter A. Randall, Portsmouth, N.H., and reprinted in 1980 & 2001.)
- Cunningham, Richard N. *The Burying Grounds of Old Newbury*. Newbury, Mass.: 375th Anniversary Committee, 2005.
- Currier, John J. (1834-1912). *Ould Newbury: Historical and Biographical Sketches*. Boston, Mass.: Damrell & Upham, 1896. (Republished in 2000 by Essex Books, Lecanto, Fla.)
- Currier, John J. (1834-1912). *History of Newburyport, Mass. 1764-1905, Vol. 1 & 2*. Newburyport, Mass.: Currier, 1906-1909. (Republished in 1996 by Higginson Book Co., Salem, Mass.)
- Currier, John J. (1834-1912). *History of Newbury, Mass. 1635-1902*. Boston, Mass.: Damrell & Upham, 1902. (Republished in 1985 by the Newbury 350th Committee.)
- Cushing, Caleb (1800-1879). *The History and Present State of the Town of Newburyport*. Newburyport, Mass.: E.W. Allen, 1826. (Republished in 1989 by Amundsen, Decorah, Iowa.)
- Goodman, Robert Lord. *Newbury, Massachusetts, 1635-1685: The Social Foundations of Harmony and Conflict*. East Lansing, Mich.: Michigan State University, 1974.
- Smith, Sarah Emery (1787-1879). *Reminiscences of a Nonagenarian*. Newburyport, Mass.: W. H. Huse, 1879.
- Smith, Euphemia Vale (1817-1904). *History of Newburyport: From the Earliest Settlement of the Country to the Present Time, with Biographical Appendix*. Newburyport, Mass.: 1854. (Republished in 1996 by Higginson Book Co., Salem, Mass.)
- Town of Newbury, Mass. *Images From the Past: 1635-1985*. Newbury, Mass.: Town of Newbury, 1985.
- Uscilka, Jane M. *The Newburyport Black Heritage Trail : Searching for African-American History in Newburyport*. Newburyport, Mass.: Uscilka, 2002.

Newbury origins in brief . . .

In 1633 a group led by ministers Thomas Parker and James Noyes were granted approval to emigrate to the Massachusetts Bay Colony. That same year, Richard & Stephen Dummer, Richard Saltonstall, and Henry Sewall and others in Wiltshire planned to launch a stock-raising enterprise in the colony to take advantage of rising markets in England. The two groups joined together – a total of about 100 people – and in 1634 crossed the Atlantic in one of the 22 ships that brought settlers to the Mass. Bay Colony that year.

Settlers arriving in 1634 were advised to settle in outlying areas. The future Newbury stock-raising company spent the winter of 1634-35 in Agawam (now Ipswich), and explored the possibility starting their enterprise further north in Quascacunquen (now Newbury). Accounts of the time describe the area as thick with timber and accessible only by a narrow, winding footpath. The name was changed to Newbury in May 1635.

Rowing shallows through Plum Island Sound, the first settlers proceeded up what is now the Parker River, landing on the north shore just east of the Parker River Bridge on Rte. 1A.

The first summer was spent clearing land, building shelters, and preparing for the next winter. Depending on the amount invested, settlers were allotted a certain amount of land for a house lot, planting lot, and salt meadow. Most houses were clustered around the Lower Green, where the meeting house was built. The largest

landowners were Richard Dummer's group, with over 1000 acres devoted to raising the sheep and cattle that arrived on ships that summer. Richard Dummer was also granted the right to build a sawmill and a grist mill further up the Parker River.

All settlers were taxed to support the Congregational Society, and were required to attend worship at the meeting house. Thomas Parker was the minister. Men were required to bring weapons to church as protection from the threat of hostile Native Americans.

By 1642 settlement began around the Upper Green. Whereas settlers had been granted half-acre building lots at the Lower Green, they were granted 4-acre lots on the Upper Green, where a new pond was formed for watering cattle. In the mid-1640s there was also increasing activity at "The Waterside" (Newburyport). A ferry was in operation across the Merrimack River, and several "mariners" built dwellings, "fish houses," and wharves near the intersection of Water & Federal Sts. By 1646 land was apportioned along the Merrimack River to the mouth of the Artichoke River. By this time the Native American threat had passed.

In the ensuing decades domestic and foreign trade grew, and the Newbury "waterside" became an active port. In 1764, Newburyport was incorporated as a separate town, as its residents felt their concerns were entirely different from the agricultural interests of Newbury. In 1851 Newburyport became a city. Since then the trials and triumphs of the city are well-known. Meanwhile, Newbury (and West Newbury, incorporated 1819) retain their rural character today.

(This brief historical sketch was compiled from the sources listed in the above bibliography.)

***Please see other side for town, library,
museum, county, state, & federal resources***

Family Genealogy Day at SPENCER-PEIRCE-LITTLE FARM

Newbury, Massachusetts



~ Guide Schedule ~

TIME	TOUR / EVENT / PROPERTY	GUIDE STAFF <small>i.e.</small> "Genealogy Day Resident Scholars On Duty"
10 a.m.Registration & Orientation at SPL Farm Introduction to Newbury Local History	
10 a.m. - 5 p.m.Genealogy Resources: Libraries & Organizations* at SPL Farm Visitor Center	
10 a.m. - 5 p.m.Self-guided walking tours of Spencer-Peirce-Little Farm	
11 - 11:45 a.m.Tour - Spencer-Peirce-Little House in the 18th Century	
11:30 - 12:15 p.m.Tour - Spencer-Peirce-Little House in the 19th Century	
12:00 - 12:45 p.m.Tour - Spencer-Peirce-Little House in the 20th Century	
1 p.m.Lunch (For box lunches ordered at time of pre-registration)	
11 a.m. - 4 p.m.Coffin House (tours on the hour)	
12 noon - 4 p.m.Swett-Ilsley House (drop-in tours)	
12 noon - 4 p.m.Tours - Cushing House Museum	
1 p.m. - 4 p.m.	On-site Orientation - First Parish Burying Ground - First Settlers Burying Ground	
2 - 4 p.m.Rocky Hill Meeting House (drop-in tours)	
3:00 - 3:45 p.m.Tour - Spencer-Peirce-Little House in the 18th Century	
3:30 - 4:15 p.m.Tour - Spencer-Peirce-Little House in the 19th Century	
4:00 - 4:45 p.m.Tour - Spencer-Peirce-Little House in the 20th Century	
4:30 p.m.Concluding Question/Answer Session at SPL Visitor Center	
<p>Participants at the SPL Farm Visitor Center include</p> <p>10 a.m. - 5 p.m.</p>	<ul style="list-style-type: none"> • New England Historic Genealogical Society • Newburyport Public Library • Newbury Public Library • Historical Society of Old Newbury (Cushing House Museum) • Essex Society of Genealogists • Newbury 375th Anniversary 1635-2010 Committee • Sons & Daughters of the First Settlers of Newbury 	

Not specifically scheduled in the morning . . . or other times? If attendance is considerably above expectations, you may be pressed into service as we break visitors into smaller groups.

N.B.: You are responsible for mastering the content of your specific tour.
(See the "Century Tours" sheet for more information.)



**HISTORIC
NEW ENGLAND**

Defining the past. Shaping the future.

Regional Office:
Spencer-Peirce-Little Farm
5 Little's Lane
Newbury, MA 01951
(978) 462-2634

Family Genealogy Day at SPENCER-PEIRCE-LITTLE FARM

Newbury, Massachusetts



~ SPL 'Century' Tours ~

Dear SPL Colleagues:

For Family Genealogy Day on Saturday, July 15, 2006 we will depart from the customary "walk through time" tour that covers the entire history of the house, and instead present three different tours with content divided roughly by century. The rationale is that with so many people living today throughout the U.S. with roots in Newbury – and with a tiny percentage at Family Genealogy Day – the focus of the tours should be "Newbury in its time" or the evolution New England domestic & farm life, i.e. "the house in its time," rather than a focus only on SPL's deeded owners. This approach does not intend to minimize the great family stories the house has to tell, but the tours by century allow us to broaden our scope to include anyone and everyone that may have had a connection to the house, the farm, or Newbury in general.

The tours by century will draw on the same material you already know well, but you'll just be "repackaging" it in a different form. I think you'll find that in the tours by century you will be able to go into greater detail about different aspects of the house. Here are my thoughts on the content of the three tours. I envision a different entry point for each:

SPL House/Farm in the 18th Century (House Highlights: *Front porch entry, Peirce chamber, Tracy bedroom*)

- Outside: A look back to Newbury in its period of settlement; SPL Farm *in the context of local history*.
- The Peirce Period 1651-1777. Daniel Peirce, Sr. & Jr.; construction of the house - materials, style, methods, etc.
- Of all periods of the house's interpretation, we know the least about the early 1700s. Therefore this tour provides the opportunity to go into more detail about the original construction, the discovery of the section of original window in the attic, the interpretation of the upstairs chamber with the large fireplace, etc.
- The Tracy Period 1777-1797. The rise & fall of the family's fortunes; Revolutionary War context.

SPL House/Farm in the 19th Century (House Highlights: *Boardman hall entry, parlor, attic, Little sitting room*)

- The Boardman Period 1797-1813. We are fortunate to have plenty of documentation of this period. The Boardman Period is also further illuminated by the BU archaeological dig.
- The Pettingell Period 1813-1861. The farm was run on a kind of "sharecropper" basis during this period, and there is scant documentation of who lived at the farm. Since there is not much specific information on the house during this period, this tour could amplify on *historical context of the period*, the growth of Newburyport industry, expansion of the railroads, etc. Much of the attic graffiti may come from hired farmhands during the Pettingell period.
- The Little Period 1851-1986. We are fortunate to have ample documentation of this period in the farm's history. (See the information sheet I prepared for Plow Match for details about the Little's draft horse business.)

SPL House/Farm in the 20th Century (House Highlights: *Kitchen entry, dining room, retrofit bathroom, view ports*)

- The Little Period 1851-1986. The 20th century holds the story of the cooperative relationship between the aging Little ladies and the hard-working immigrant tenant farmer.
- Jacob Stekionis (1891-1984) & family - 1913-1984. There is plenty of information & interviews about the family's experience and observations in the SPL binder – a lot of good *20th century context*. A peek into the tenant house kitchen?
- SPNEA/Historic New England preservation. The 20th century also holds the story of how the property came to be acquired by SPNEA in 1986. The 20th century tour is the place to point out the monumental structural work undertaken to preserve the building for future generations.

If you have any questions . . . or ideas to contribute to these "tours by century" please don't hesitate to let me know. Thanks for any and all thought you put into the above!



Reg Bacon
978-462-4407
rwbacon@comcast.net

Regional Office:
Spencer-Peirce-Little Farm
5 Little's Lane
Newbury, MA 01951
(978) 462-2634